

# OFS-FILTER SHUT-OFF NOZZLE TYPE VSR

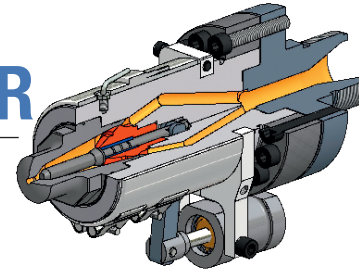

That **OFS**-nozzle is combined of a filter- and a needle shut-off system.

### APPLICATION FIELDS:

The **OFS**-filter shut-off nozzle type VSR prevents a leakage at the nozzlehead after injection. It also allows the plasticizing during dosing. Dependent on the injection molding machine, the nozzle can be activated by pneumatic or hydraulic. Due to the optimal rheological design of the filtertorpedo it is also possible to process technical and reinforced materials. At reinforced materials, we recommend special coatings. The coatings counteract the abrasive and corrosive attacks of the reinforced materials and increase the life span of the nozzle.

### CLEANING EFFORT:

simple handling  
(several steps in correct order)

### FILTRATION GAPS:

filtertorpedos with filtration gap S up from 0.25 mm are available

### HANDLING:

1. Pressure relief (move back the screw).
2. Lift of aggregate.
3. depressure the pneumatic or hydraulic valve.
4. Screw out nozzlehead to the marked of cleaning- position (ring spanner is included in the delivery).  
**! Attention, safety warning, screw out only to marked position !**
5. Reduce injection pressure. Spray off once or twice in the open air. Observe the safety- regulations!
6. Screw in nozzlehead (6) and tighten it.
7. Start again process of moulding injection.

### SHOT WEIGHTS:

The possible shot weight is dependent on the material, the filtration gap and the injection time. The **OFS**-filternozzle type VSR is offered in two sizes. As a clue, the following datas can be used (filtration gap S= 0.6 mm and material PS)  
type SII → appr. 500 g  
type SIII → appr. 1.200 g

### MORE OPTIONS:

- ▶ nozzlehead with dip nozzle
- ▶ nozzlehead with interior thread
- ▶ with mixing insert etc.

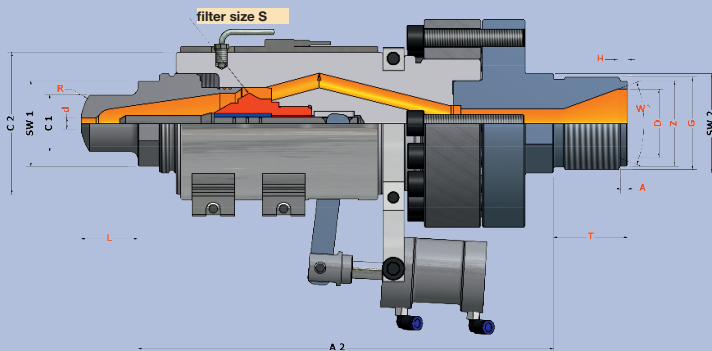

### DATA AND STANDARD DIMENSIONS (mm)

		VSR II	VSR III
possible shot weight	gr.	600	2.000
max. injection pressure	bar	2.300	2.300
length	A2	245	300
nozzlehead dia	C1	30	40
nozzlebase dia	C2	80	100
hexagon nozzlehead	SW1	46	60
hexagon nozzlebase	SW2	60	80

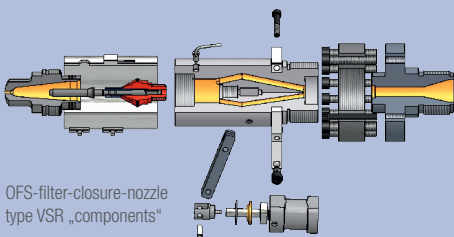

OFS-filter-closure-nozzle type VSR „components“

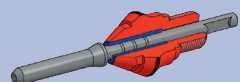

OFS-filtertorpedo with OFS-needle type VSR

REQUIRED MEASUREMENTS		
machine thread	G	
T/A/D/Z/W°/H		specify if required
filtration gap	S	
length of nozzlehead	L	
drill	d	
radius / surface	R	

REQUIRED PARAMETERS		
material (MFI)		
shot weight	gr.	
melt temperature	°C	
injection time	sec	
injection pressure spec.	bar	
machine type		
screw dia	mm	